

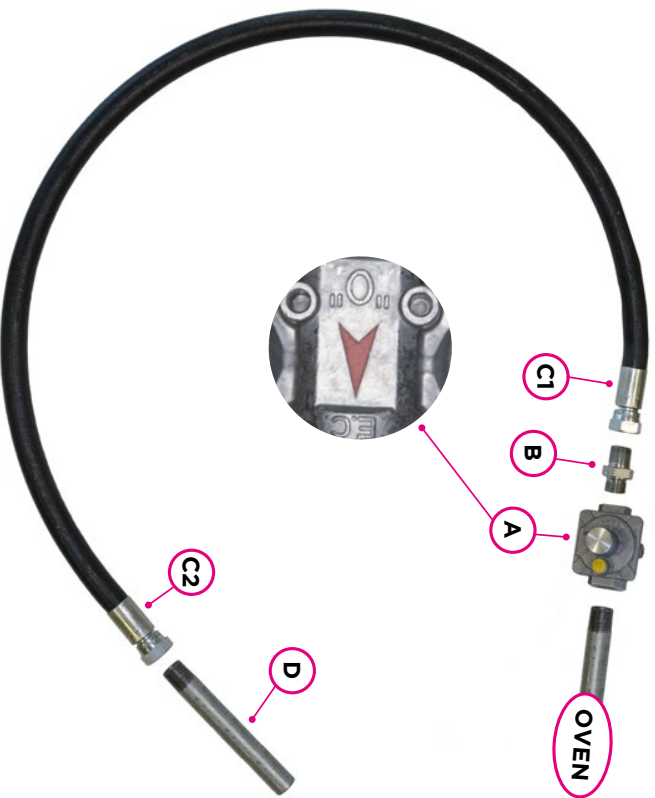

NORTH AMERICA ONLY

GAS CONNECTION AND INSTALLATION

THIS OVEN COMES FROM THE FACTORY SET UP FOR NATURAL GAS HOOK UP



CONNECTION KIT

- A** - Regulator connect to oven
- B** - BSPP - NPT adapter
- C1** - Gas hose to oven
- C2** - Gas hose to gas supply
- D** - Gas supply piping



Mount the adapter (B) on the gas inlet (C1), followed by the regulator (A).



Connect the gas supply (D) to the gas hose (C2)

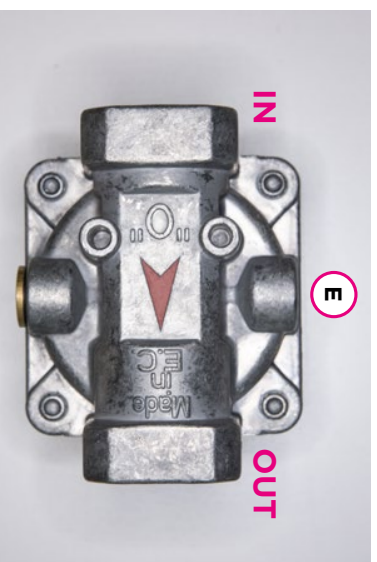

CAUTION

Respect the direction indicated by the arrow to connect the regulator.



NORTH AMERICA ONLY

CONNECTION TO THE GAS CYLINDER

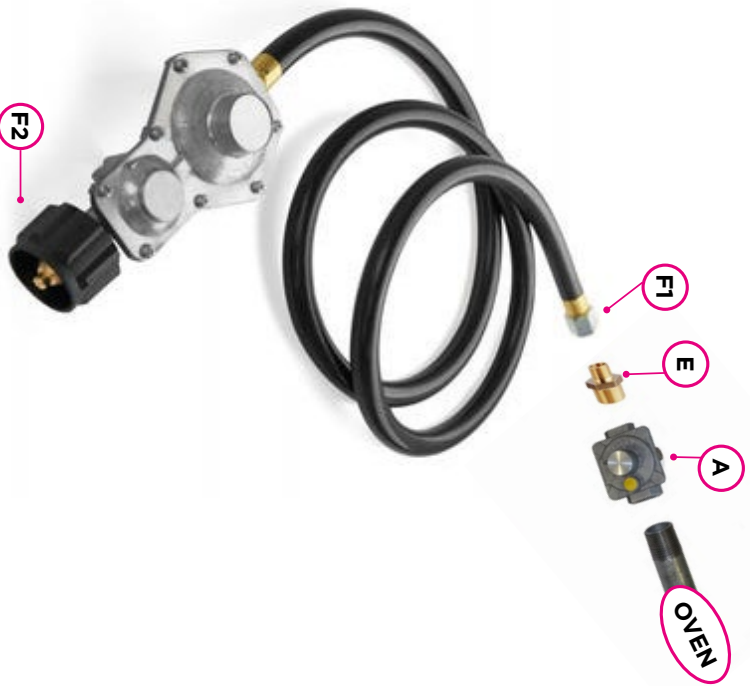

- A - Regulator connect to oven
- E - 1/2" male gas fitting (3/8" OD Flare x 1/2" MIP - Tapped 3/8" FIP
- F1 - LPG hose connect to oven
- F2 - LPG hose/regulator connect to propane gas cylinder.

CONNECTION KIT

Connect Regulator (A) to the oven.
 Connect Propane Hose (F1) to the Regulator (A) using 1/2" Male Gas Fitting (E) - 3/8" OD Flare x 1/2" MIP - Tapped 3/8" FIP.
 Connect Propane Hose/Regulator to Propane Gas Cylinder

*use gas seal tape or pipe thread sealant where needed

CONVERTING YOUR OVEN

Begin by Converting the Regulator to LPG

- 1- Natural gas supply (H)



- 2- Unscrew the cap to access the regulator adjustment.



- 3- The plastic adapter should be turned upside down depending on the type of gas supply.



--4--

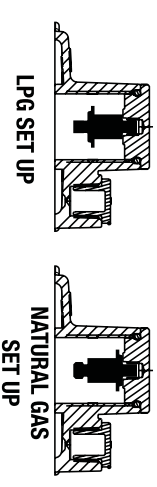

- 5- Refit the cap.





CONVERSION LPG - METHANE



ONLY USE THE COMPONENTS AND PARTS SUPPLIED WITH THE CONVERSION KIT

WARNING: The following conversion must be performed by authorized professionals when the oven is completely cold. Improper installation, adjustment, alteration can cause property damage or injury.

1 GAS KIT DISASSEMBLY

Remove the gas kit according to the instructions in the appropriate section of the manual.

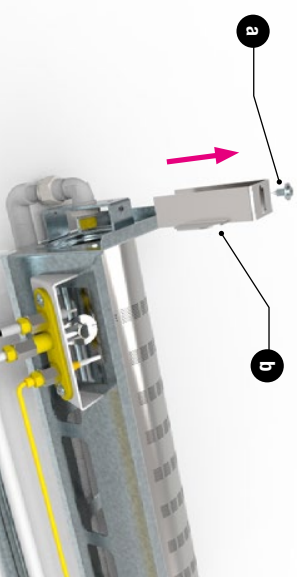

Unscrew the fixing screw (a) and remove the plate (b) covering the nozzle.

Unfasten the main nozzle (e) to the holder screw (d) by using an 11 mm spanner. Replace the nozzle with orifice supplied in the kit and screw it back to the holder (d).

During these operations, secure lock the nozzle holder (d) to keep it from rotating.

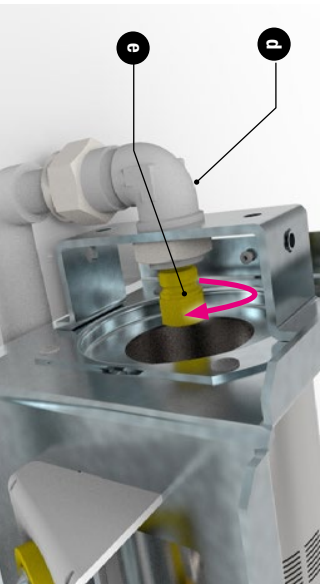

3.1 REPLACEMENT OF THE PILOT NOZZLE.

Unscrew the fixing screw (h) of the pilot light tube.

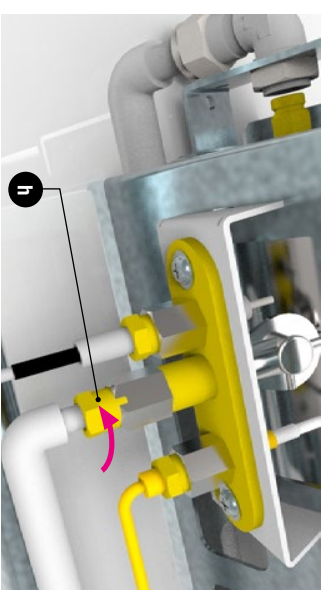

3.2

Remove the tube (i) from the seat.

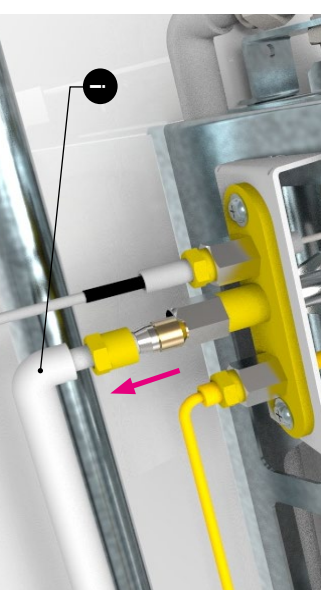

3.3

Remove the pilot nozzle (j) from the cone-like support (o) and replace it with the spare component supplied in the kit. Reassemble everything following the same steps in reverse order.

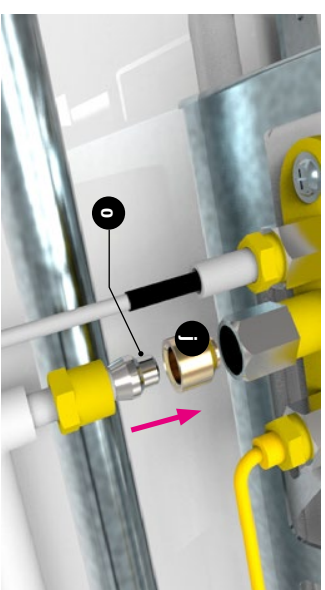

Following the conversion, apply the new label on the product and check that the size of the nozzle corresponds to that shown on the label.